

21/2

21/2

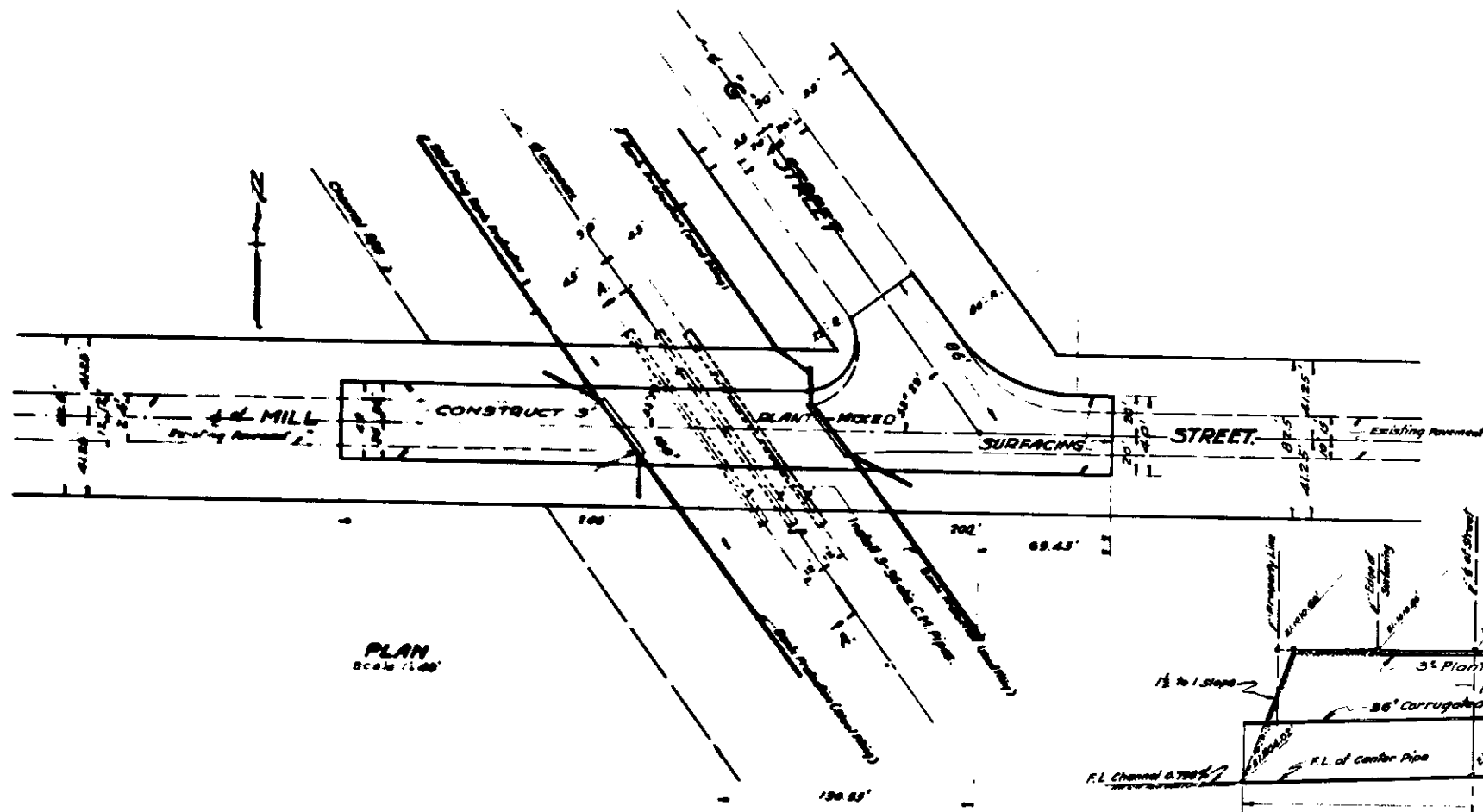

PLAN
Scale 1/4" = 10'

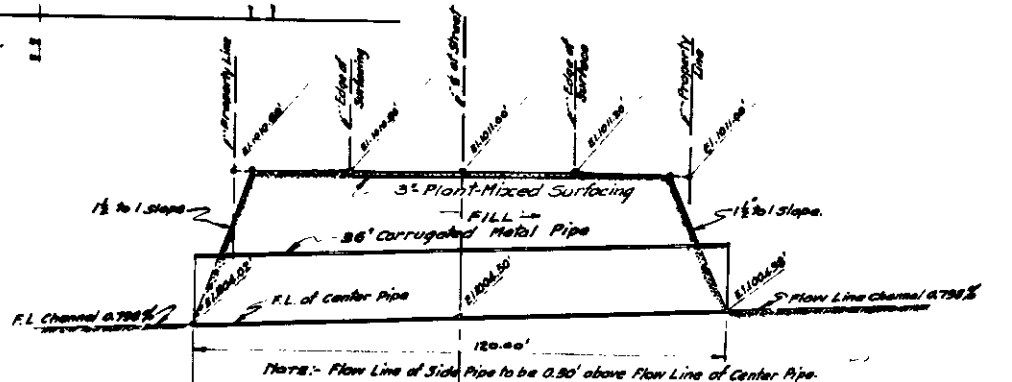

SECTION OF DIP CROSSING AT A.A.
Scale - Horizontal - 1" = 20'
Vertical - 1" = 4'

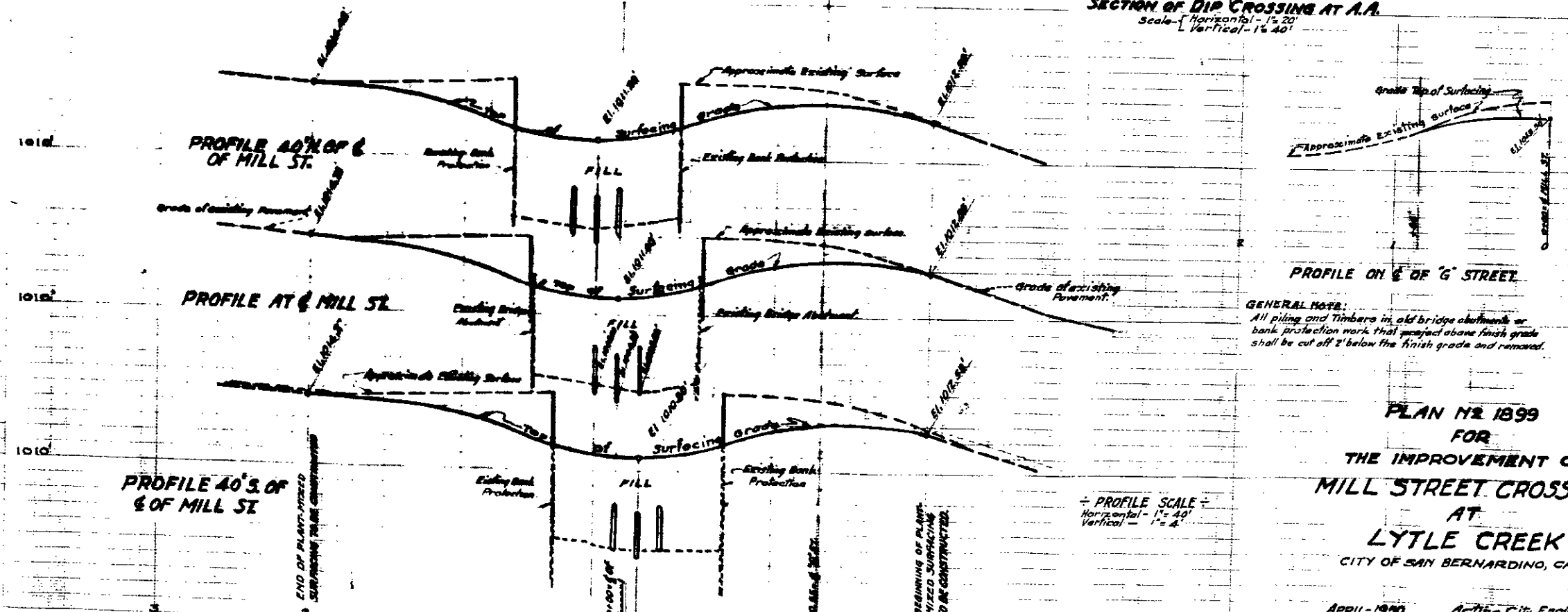

GENERAL NOTE:
All piling and timbers in old bridge abutments or bank protection work that project above finish grade shall be cut off 2' below the finish grade and removed.

PROFILE SCALE
Horizontal - 1" = 40'
Vertical - 1" = 4'

PLAN NO. 1899
FOR
THE IMPROVEMENT OF
MILL STREET CROSSING
AT
LYTLE CREEK
CITY OF SAN BERNARDINO, CALIF.

APRIL - 1930 Acting City Engineer

21/2

21/2

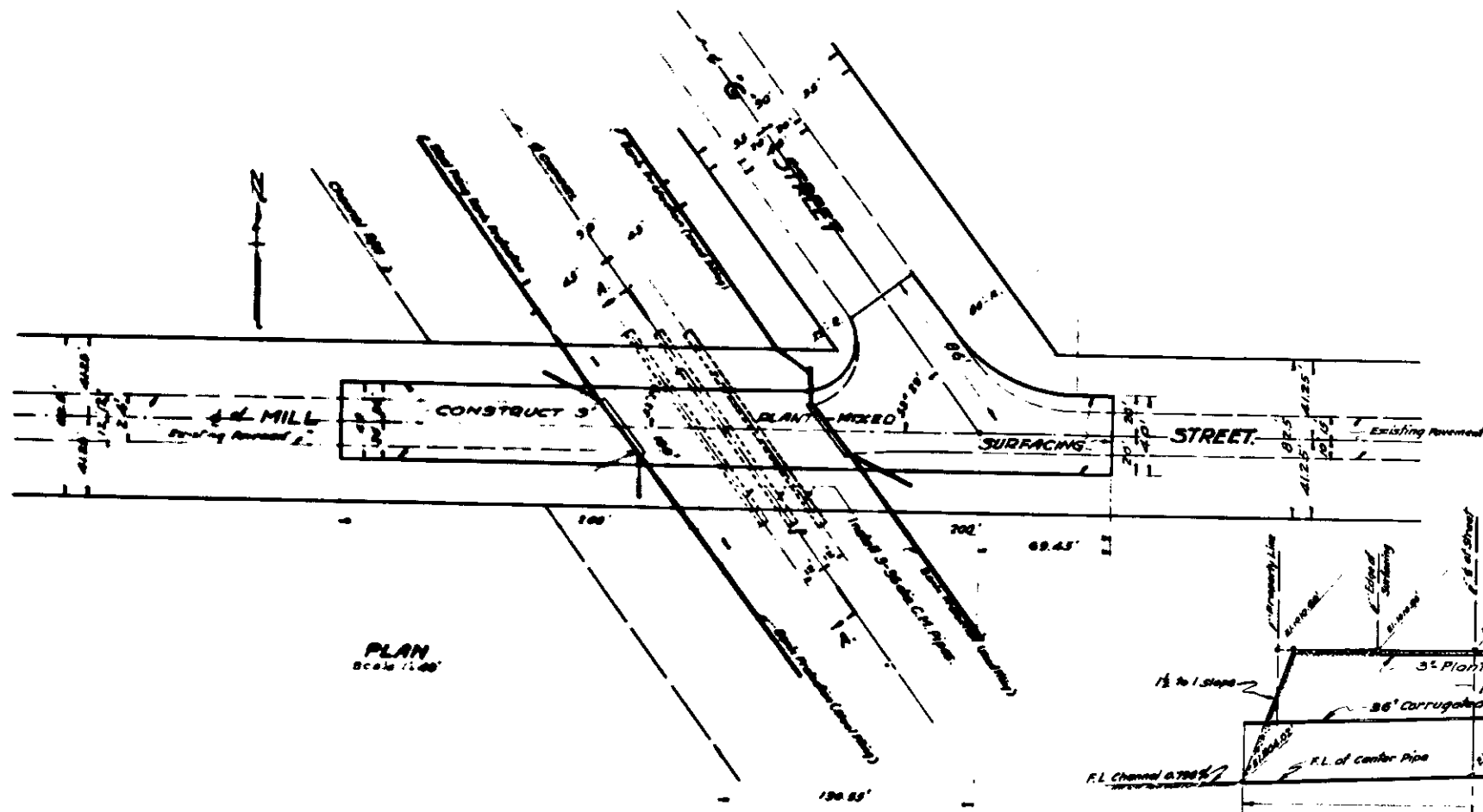

PLAN
Scale 1/4" = 10'

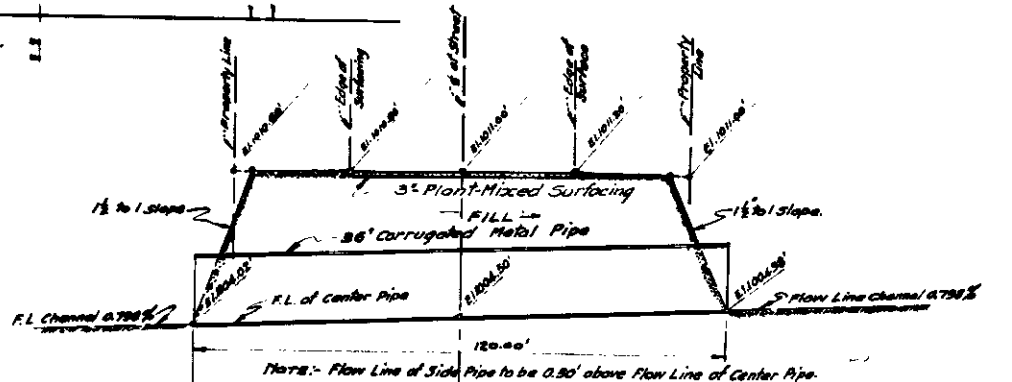

SECTION OF DIP CROSSING AT A.A.
Scale - Horizontal - 1" = 20'
Vertical - 1" = 4'

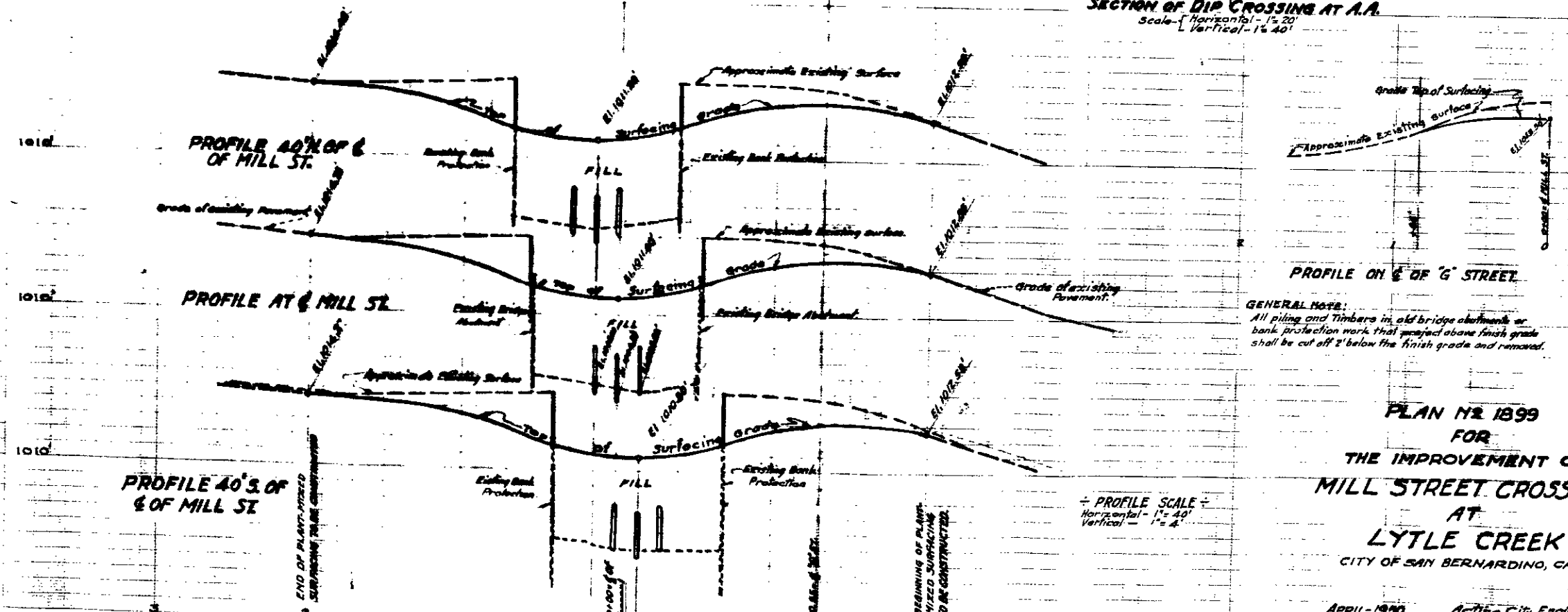

GENERAL NOTE:
All piling and timbers in old bridge abutments or bank protection work that project above finish grade shall be cut off 2' below the finish grade and removed.

PLAN NO. 1899
FOR
THE IMPROVEMENT OF
MILL STREET CROSSING
AT
LYTLE CREEK
CITY OF SAN BERNARDINO, CALIF.

APRIL-1930 Acting City Engineer

DIP CROSSING

BEGINNING OF PLANT-MIXED SURFACING TO BE CONSTRUCTED

END OF PLANT-MIXED SURFACING TO BE CONSTRUCTED

21
175

21

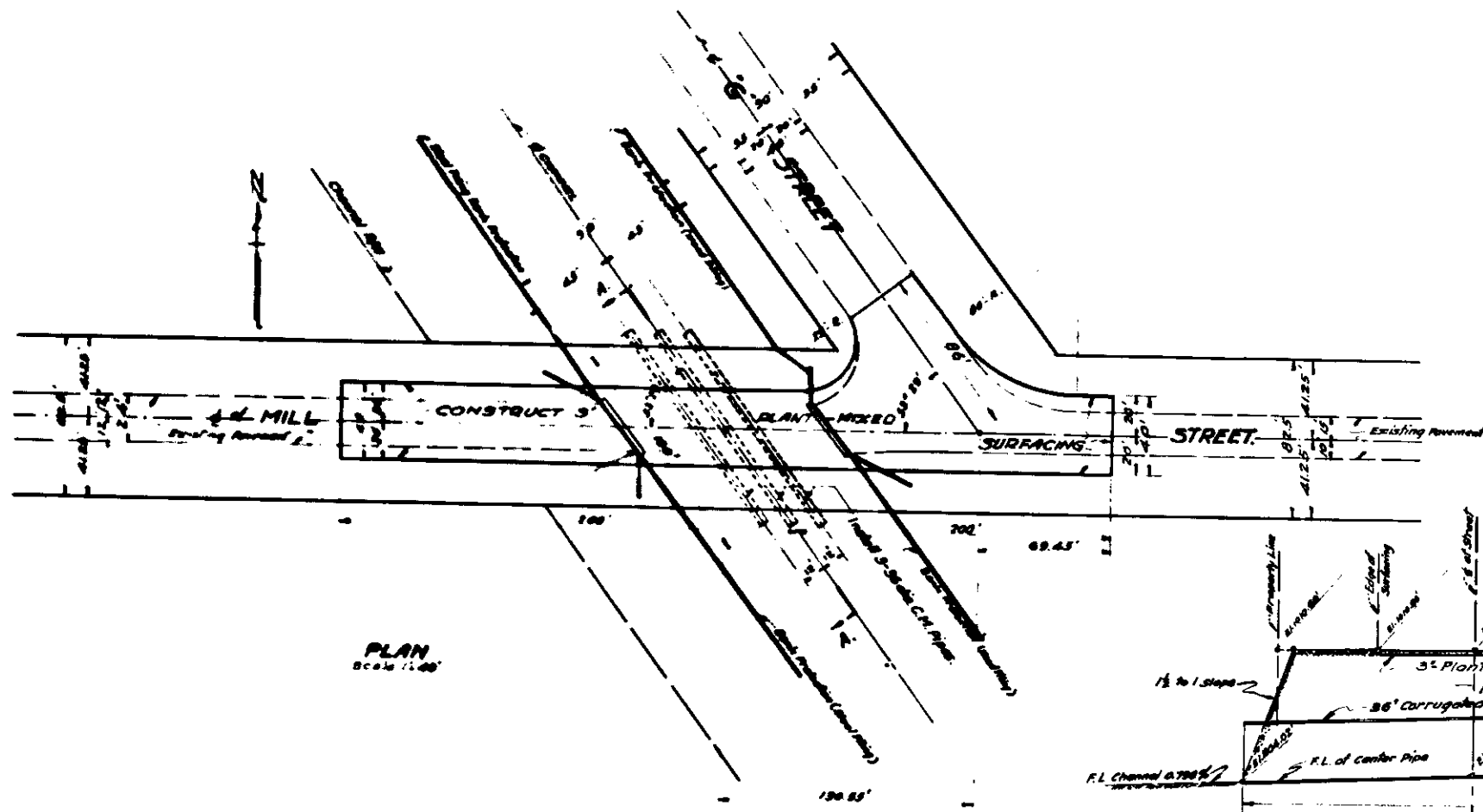

PLAN
Scale 1/4" = 10'

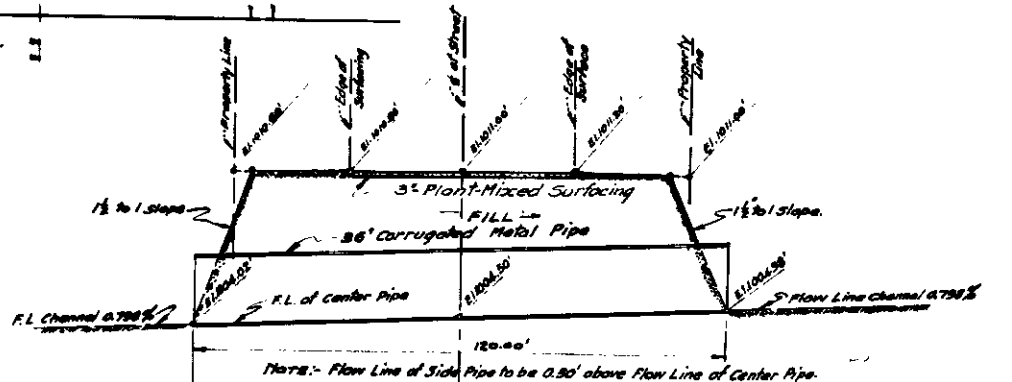

SECTION OF DIP CROSSING AT A.A.
Scale - [Horizontal - 1" = 20'
Vertical - 1" = 40']

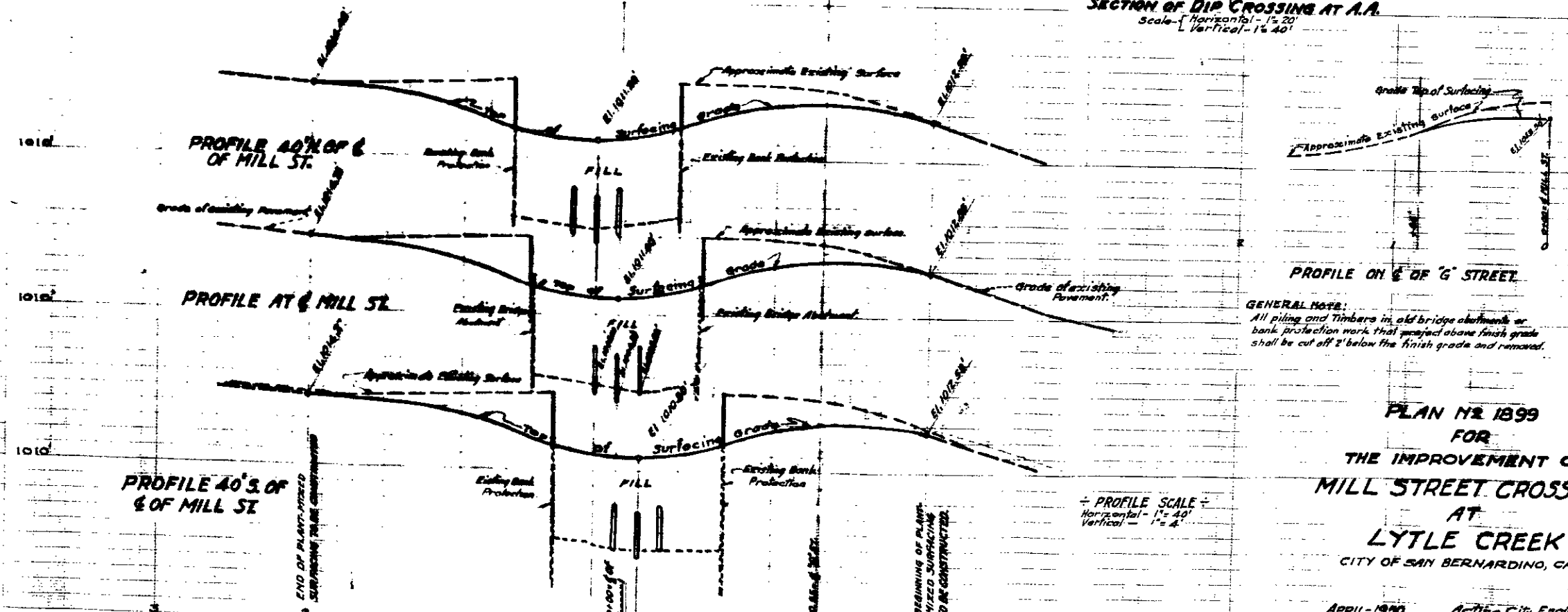

GENERAL NOTE:
All piling and timbers in old bridge abutments or bank protection work that project above finish grade shall be cut off 2' below the finish grade and removed.

PLAN NO. 1899
FOR
THE IMPROVEMENT OF
MILL STREET CROSSING
AT
LYTLE CREEK
CITY OF SAN BERNARDINO, CALIF.

APRIL-1930 Acting City Engineer